



ORGANIZER - COMPATIBLE WITH DISNEY VILLAINOUS - THE BIG BAD BOX

ORGANIZER COMPATIBLE WITH DISNEY VILLAINOUS: THE WORST TAKES IT ALL + EXPANSIONS WICKED TO THE CORE; DESPICABLE PLOTS; PERFECTLY WRETCHED; SUGAR AND SPITE; FILLED WITH FRIGHT; EVIL COMES PREPARED; BIGGER AND BADDER, WITH INCLUDED LIFTED BASE.



USE THE ORIGINAL GAME LID TO STORE THE ORGANISER



26.9 x 26.9 x 18.3 cm
SIZE ONCE ASSEMBLED

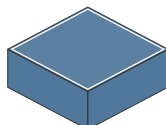

FLUSH CLOSURE WITH THE PROVIDED LIFTED BASE



FITS BOTH SLEEVED AND UNSLEEVED CARDS

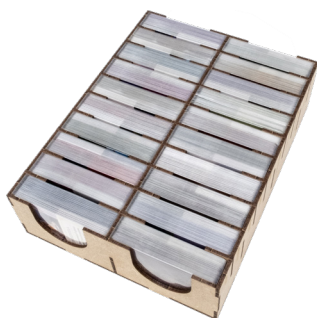

Any doubt? Check out our FAQ page or download the digital version of the instructions on our website!

All trademarks and copyrights are the property of their respective owners. This product is not a toy. Contains small parts that can be swallowed or inhaled. 14+





ORGANIZER - COMPATIBLE WITH Disney Villainous - The Big Bad Box

TUTORIAL - THE DICETROYERS DICE!

Among the pieces to assemble, you'll find a dice. This is not part of the organizer, but it can be a good starting point to practice!

Tra i materiali da assemblare troverai un dado. Questo componente non fa parte dell'organizer, né del gioco, ma è un ottimo punto di partenza per fare un po' di pratica.

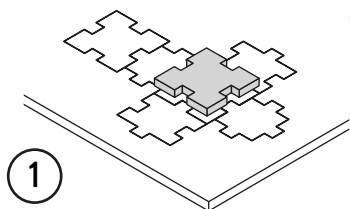

1

Gently take off
all the pieces.
Stacca delicatamente
dal foglio tutti i pezzi.

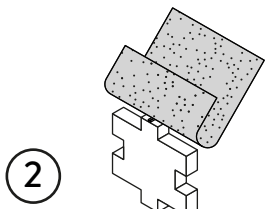

2

If necessary, use sand paper to
smoothen the borders.
Se necessario rifila con carta
vetrata per legno eventuali
imperfezioni dei pezzi.

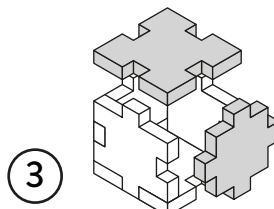

3

Get familiar with
all the pieces
and check the correct assembly
sequence.
Prendi familiarità con tutti
i pezzi, per assicurarti
che la sequenza di assemblaggio sia
corretta.

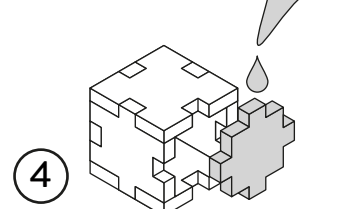

4

Once verified the correct assembly
sequence, just add a small quantity
of PVA glue on every joint.
Dopo aver verificato
la sequenza di assemblaggio
aggiungi una piccola quantità di
colla vinilica su tutti
gli incastri per garantirne
la durata nel tempo.

INSTRUCTIONS

A



203A

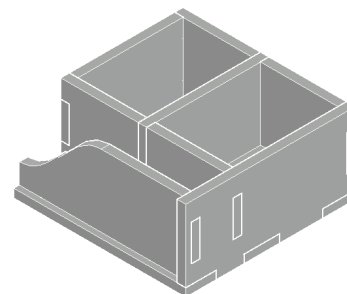
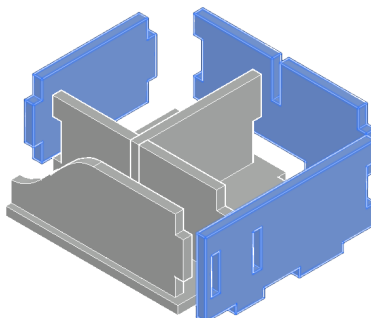
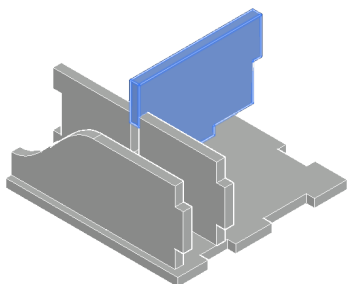
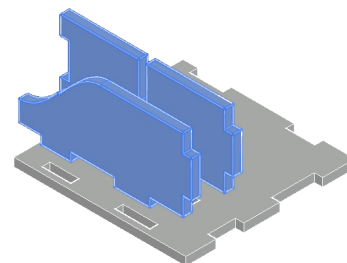
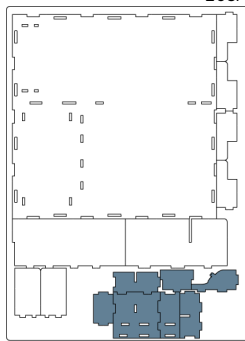

B



203E

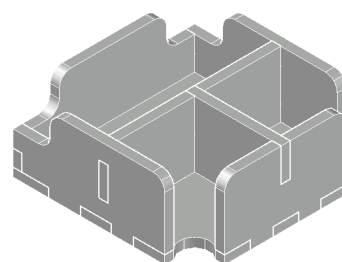
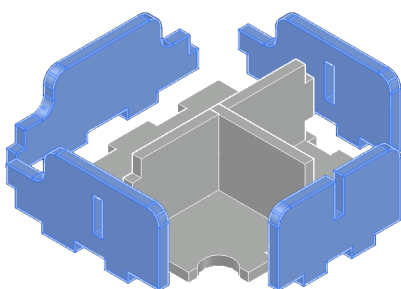
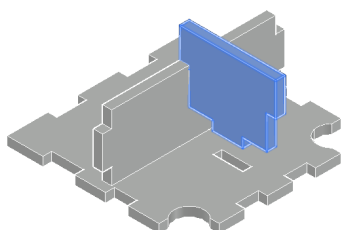
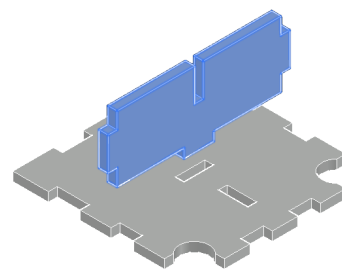
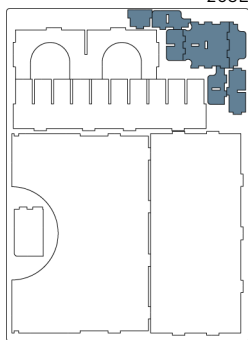

C



203F

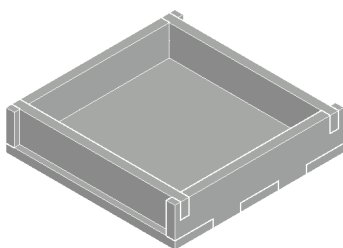
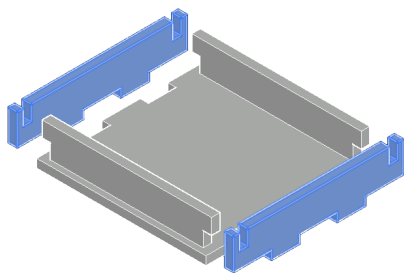
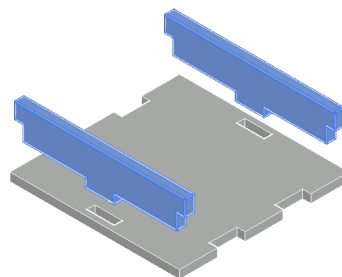
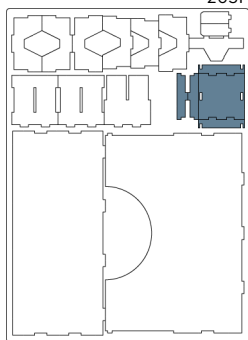

D



Cauldron's lid.
Coperchio del calderone

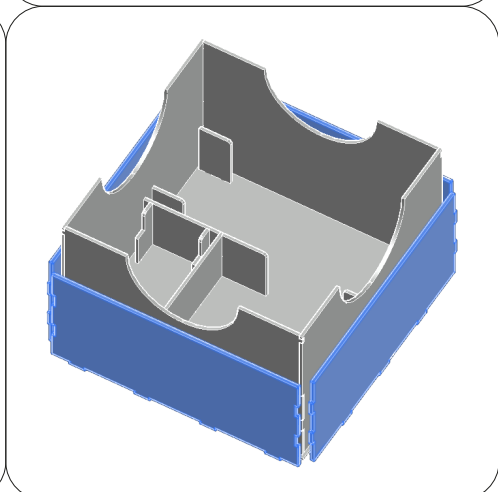
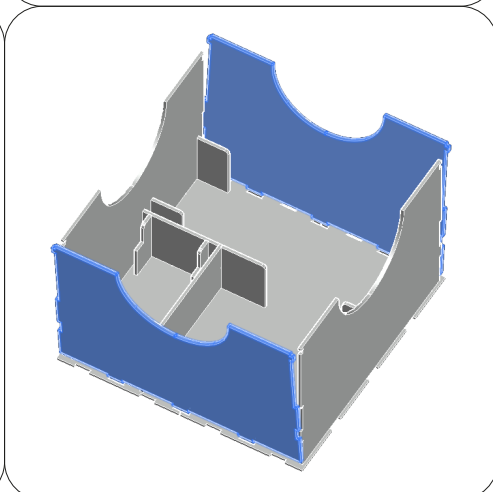
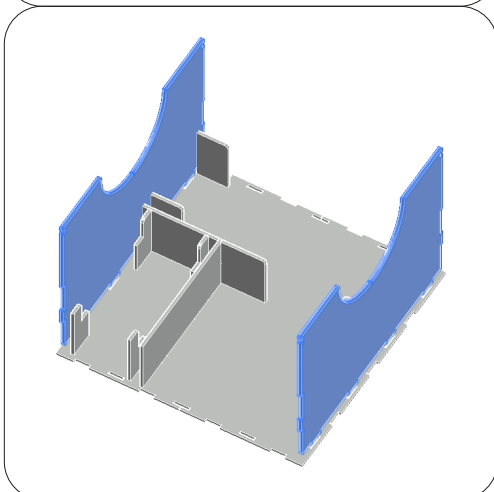
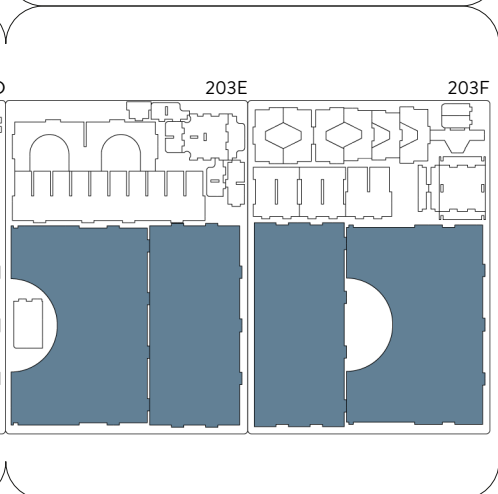
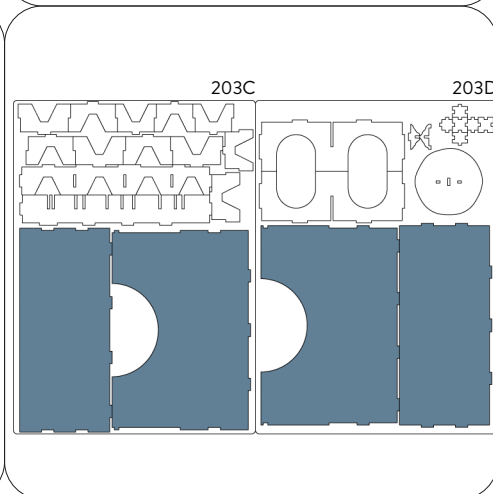
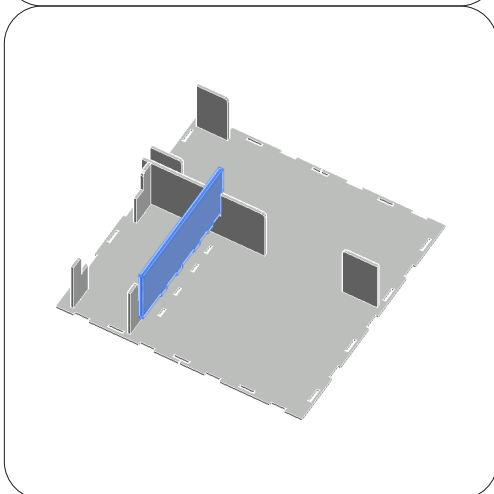
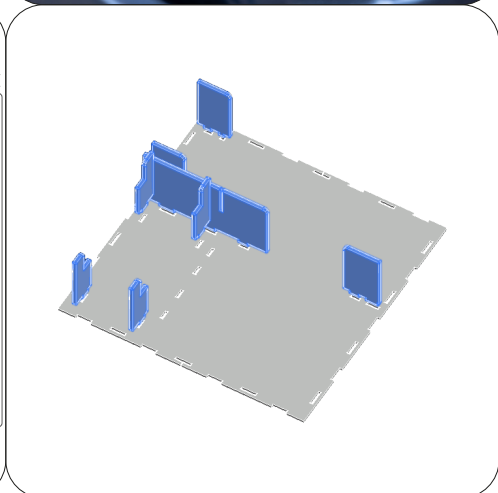
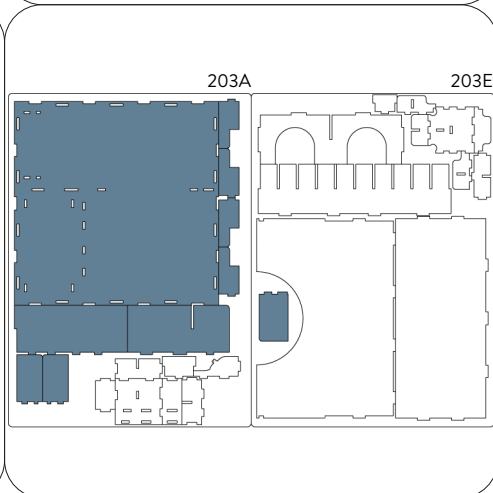
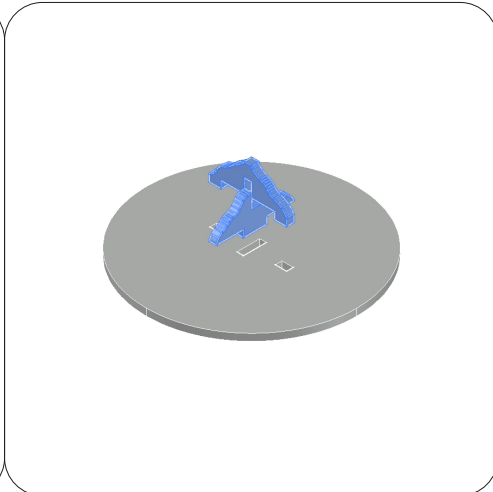
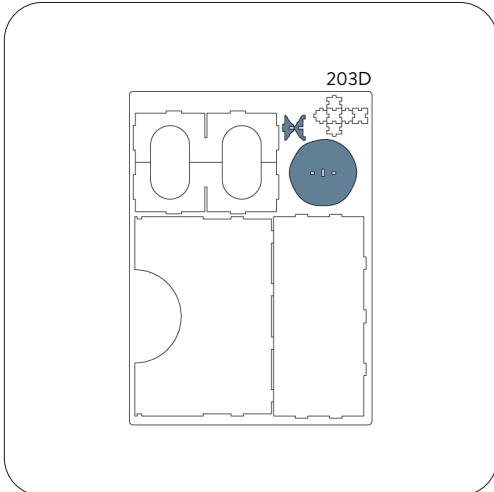

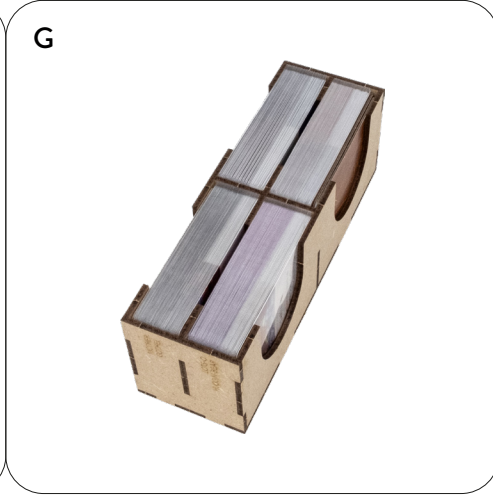
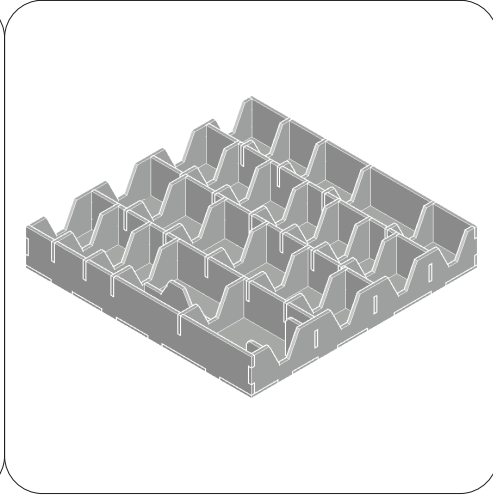
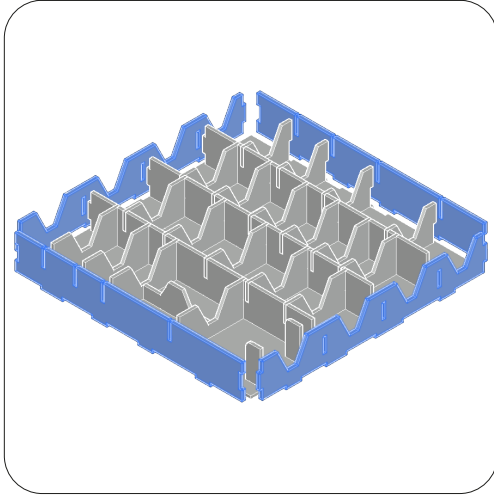
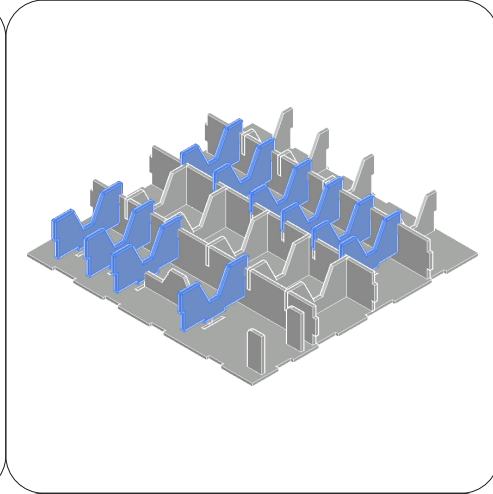
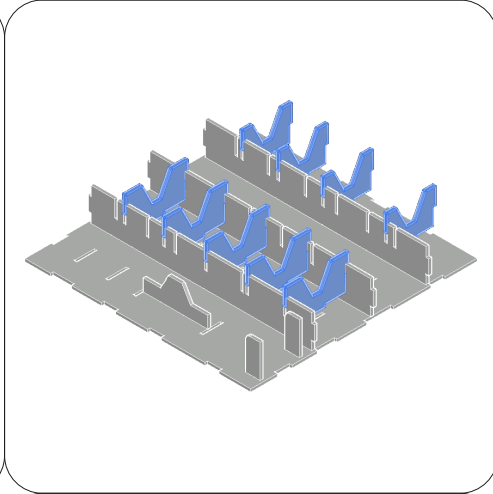
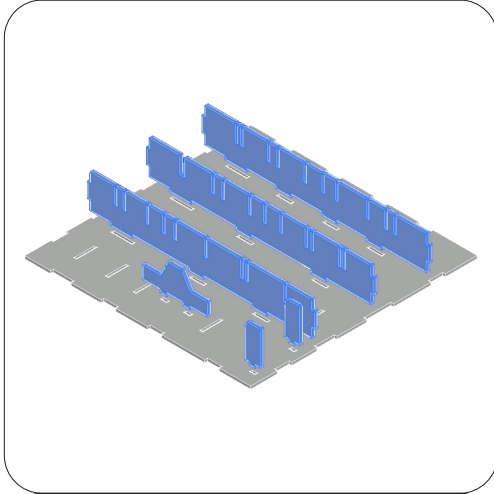
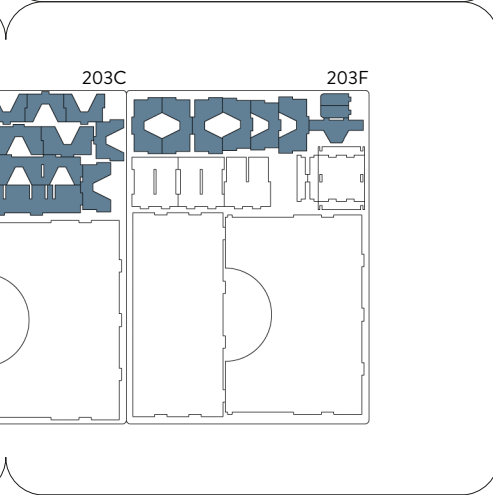
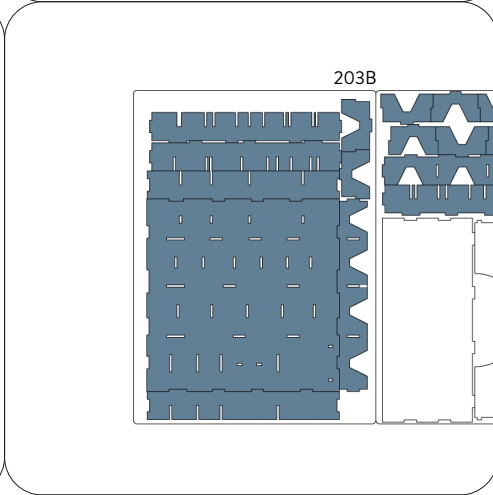
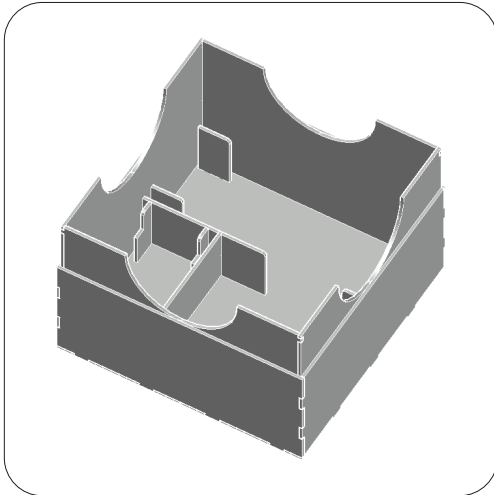

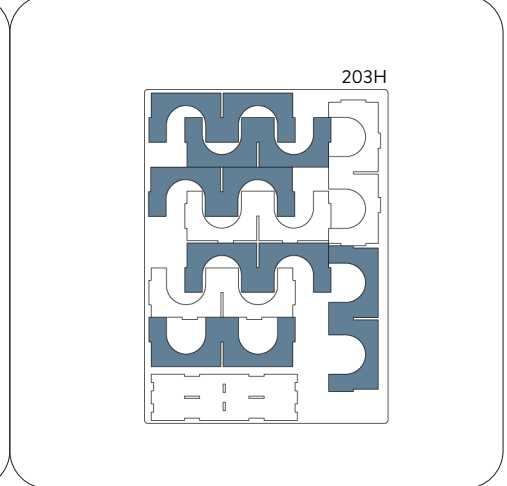
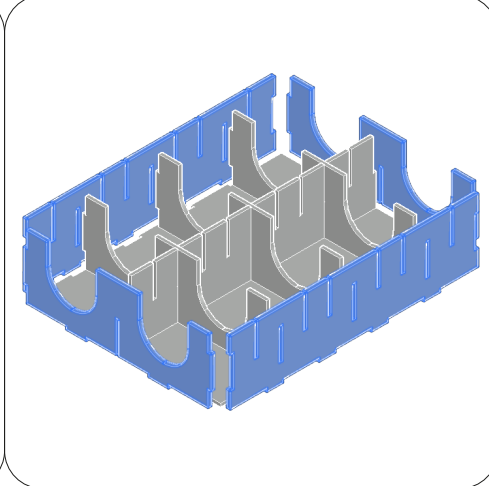
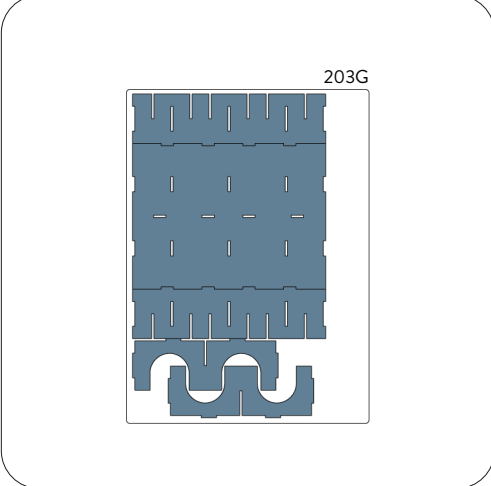
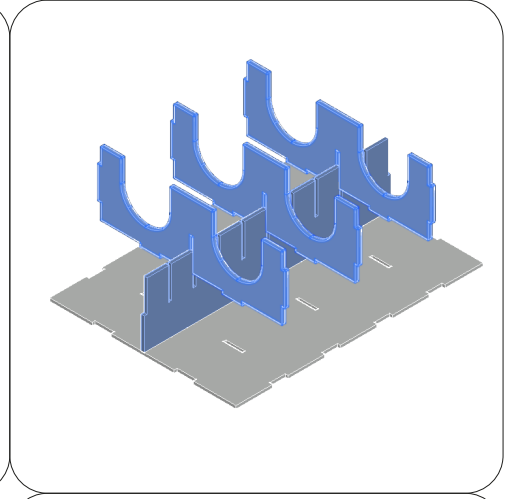
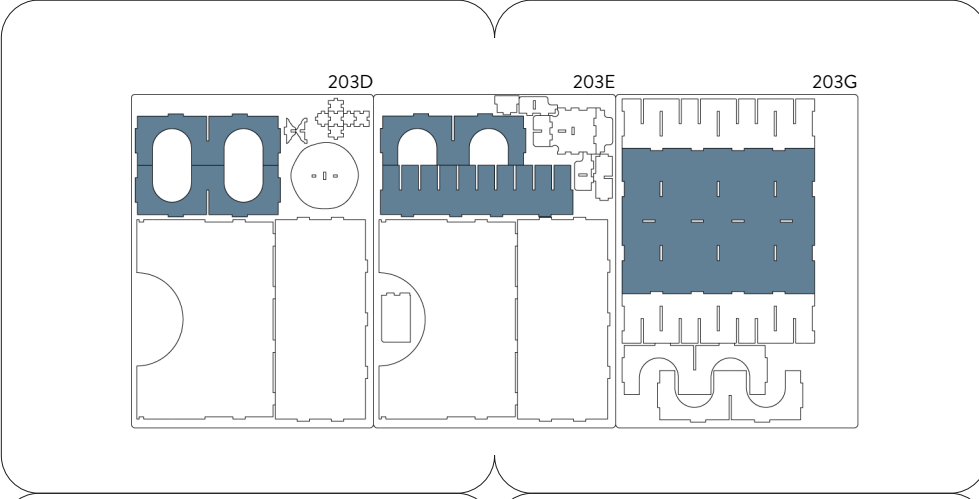
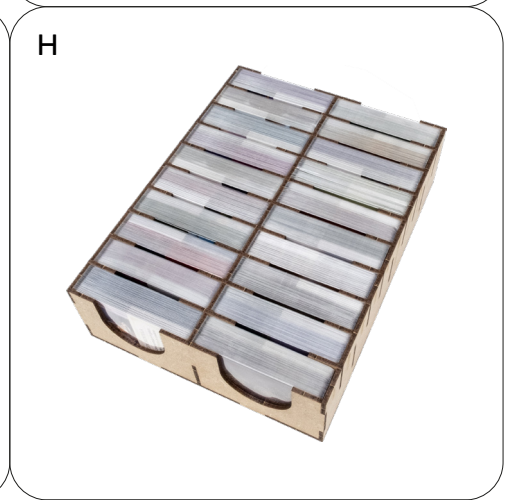
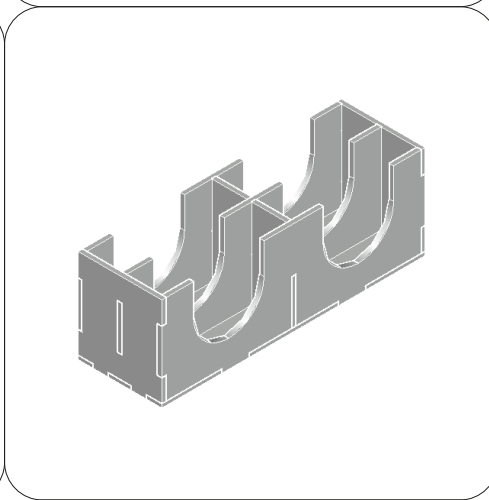
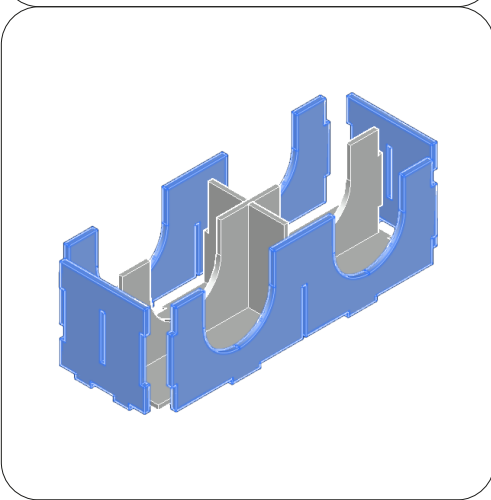
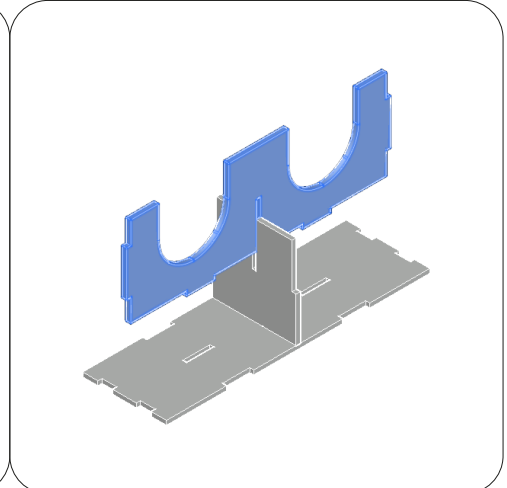
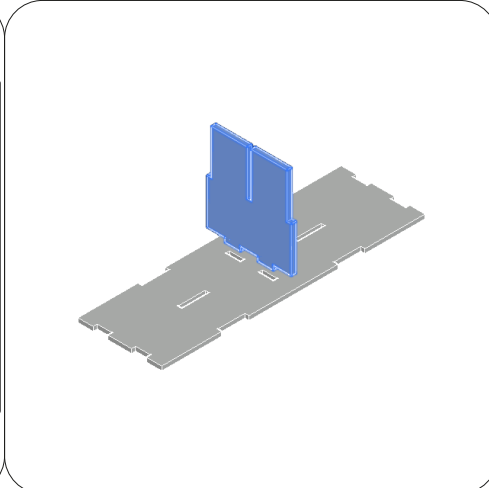
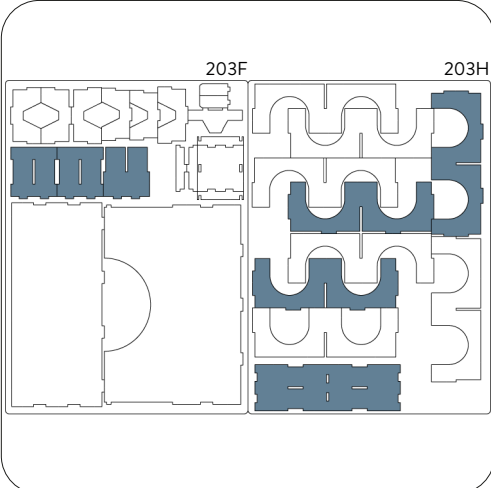



If your cards are sleeved, put these dividers without glue and test how the decks fit in the slots; the tray can be used also without them. We tested with 60micron sleeved cards. Se le tue carte sono imbustate, inserisci questi divisori senza usare colla per verificare il corretto inserimento dei vari mazzi negli slot; questo contenitore può anche essere usato senza questi divisori. Questo tray è stato testato utilizzando bustine da 60micron.

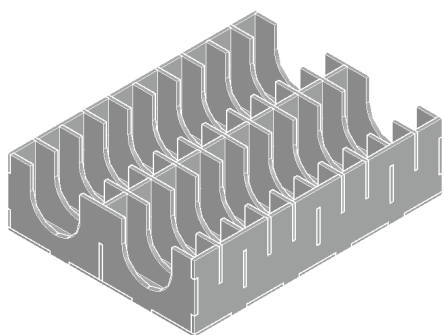
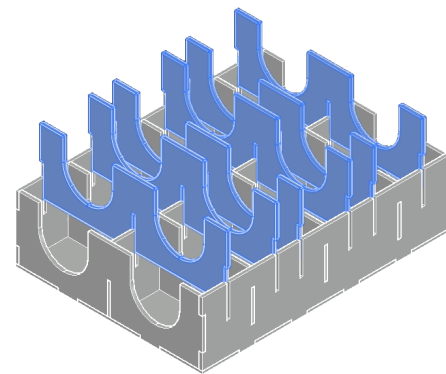

REBOXING SEQUENCE!



Non-recyclable waste.
Smaltire i materiali di scarto
nell'indifferenziata.

All trademarks and copyrights are the property of their respective owners.
This product is not a toy. Contains small parts that can be swallowed or inhaled. 14+