

PICK AND PLAY CARD HOLDER (SINGLE ROW) - CHERRY BLOSSOM -



2 Pieces to assemble
Pezzi da assemblare

22.3 x 6 x 0.6 cm

Size once assembled
Dimensioni assemblato

TECHNICAL SPECS

1x jig for assembly; 1x single track card holder. Track length 21.3 cm.

Compatible with all card sizes, sleeved or unsleeved.

1x dima di montaggio; 1x portacarte con binario singolo. Lunghezza del binario 21,3 cm.

Compatibile con tutti i formati di carte, imbustate e non.



All trademarks and copyrights are the property of their respective owners.

This product is not a toy. Contains small parts that can be swallowed or inhaled. 14+

Any doubt?
Download a full
digital version on
thedictroyers.com

1

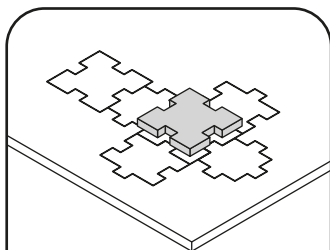

Gently take off all the pieces.
Stacca delicatamente dal foglio tutti i pezzi.

2

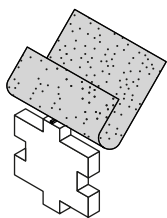

If necessary, use sand paper to smoothen the borders.
 Se necessario rifila con carta vetrata per legno eventuali imperfezioni dei pezzi.

3

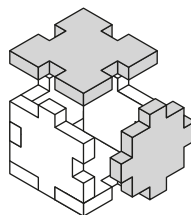

Get familiar with all the pieces and check the correct assembly sequence.
 Prendi familiarità con tutti i pezzi, per assicurarti che la sequenza di assemblaggio sia corretta.

4

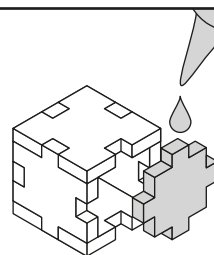

Once verified the correct assembly sequence, just add a small quantity of PVA glue on every joint.
 Dopo aver verificato la sequenza di assemblaggio aggiungi una piccola quantità di colla vinilica su tutti gli incastri per garantirne la durata nel tempo.

INSTRUCTIONS

A



DT-89A

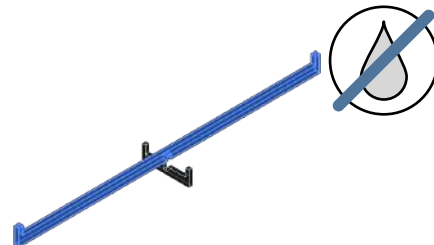
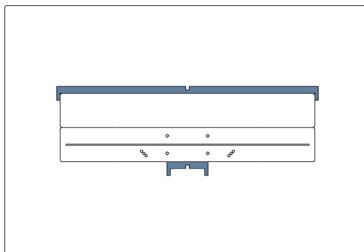

NOTE: Assemble the guides first. Don't use glue on this step and, during the other steps, be careful not to glue the card holder to the guides. Per prima cosa assembla le guide. Non usare colla su questo passaggio e durante le altre fasi presta attenzione a non incollare il portacarte alle guide.

DT-89A

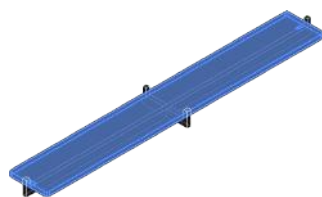
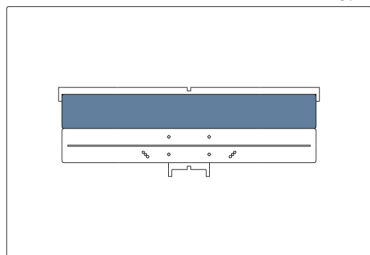

NOTE: Don't use glue on this step. Place the engraved sides facing upwards. Non usare colla su questo passaggio. Presta attenzione ai lati incisi, vanno rivolti verso l'alto.

DT-89A

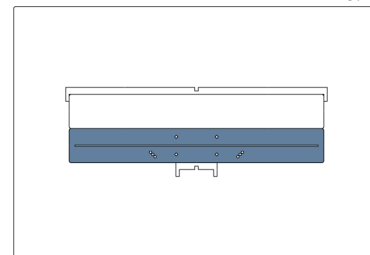



NOTE: Don't use glue on red areas. Stick the area marked in green. Non usare colla sulle aree rosse. Incollare l'area segnalata in verde.

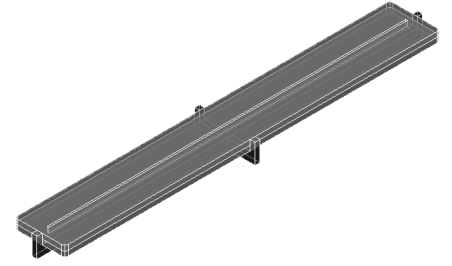
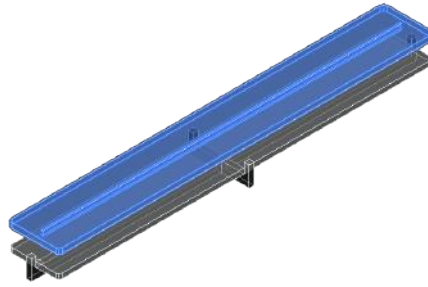

NOTE: Let the glue dry, then remove the guides. Lascia asciugare la colla. Dopodiché rimuovi le guide.

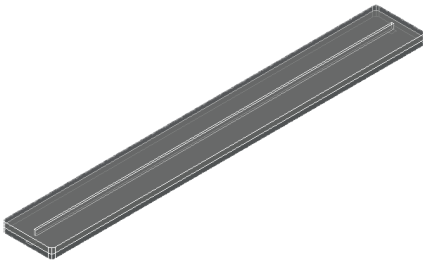

CARD HOLDERS

Did you like this product? Check out the complete collection on our website! Ti è piaciuto questo prodotto? Scopri sul nostro sito la gamma completa.

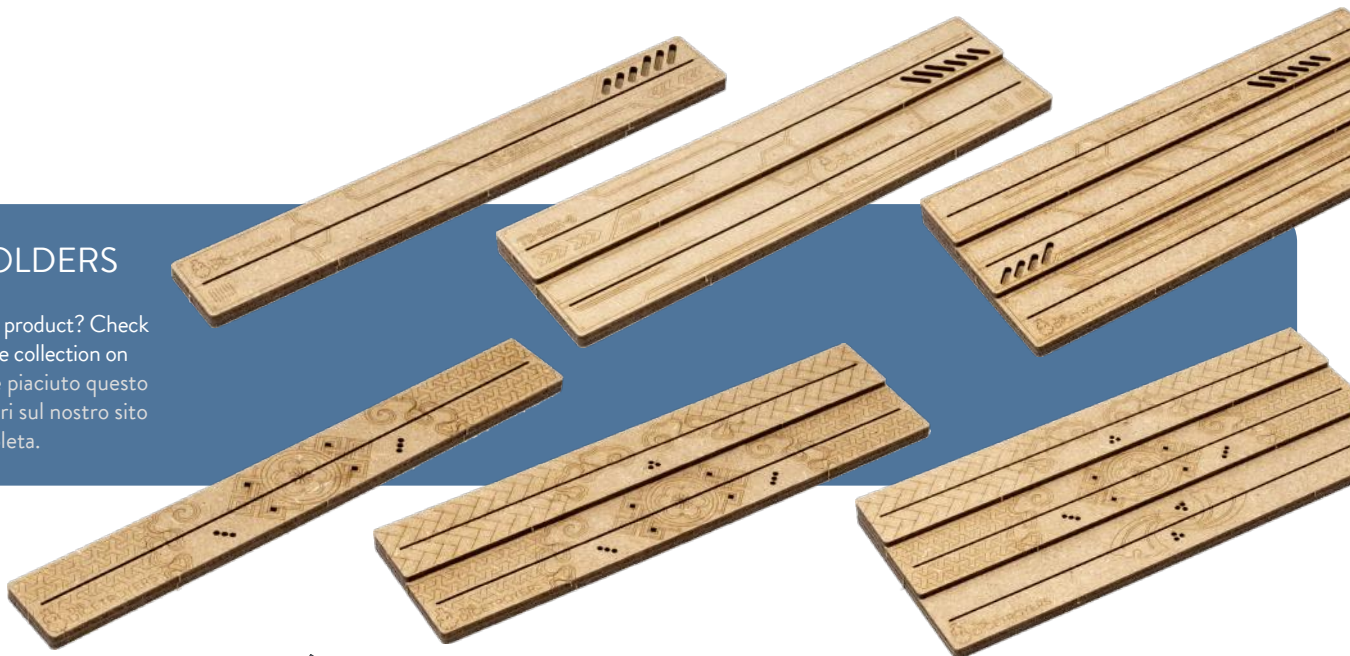

Non-recyclable waste.
Smaltire i materiali di scarto nell'indifferenziata.

All trademarks and copyrights are the property of their respective owners.
This product is not a toy. Contains small parts that can be swallowed or inhaled. 14+