

# AWKWARD GUESTS



**Angelica Albinson**

- ⚡ Poisoned chalice
- ♡ Extreme principles
- 📁 Sinister plans

**Berwick Sisters**

- ♠ Family vendetta
- ⚡ Social undermining
- 📁 Excessive ambition

**Claudette Cazelar**

- 📁 Exposed fraud
- ♡ Fatal rejection
- ⤷ Unforeseen business

**Greg Gaffney**

- ⤷ Stolen recipe
- 📁 Fixed fights
- ⚡ Animal cruelty

**Mortimer W. Mollow**

- ♡ Broken dreams
- ⤷ Pirated idea
- ♠ Child neglect

**Stanley Smithe**

- 📁 Macabre bet
- ♠ Fraternity hazing
- 📁 Fake identity

# The suspects and their motives

# The Walton Mansion

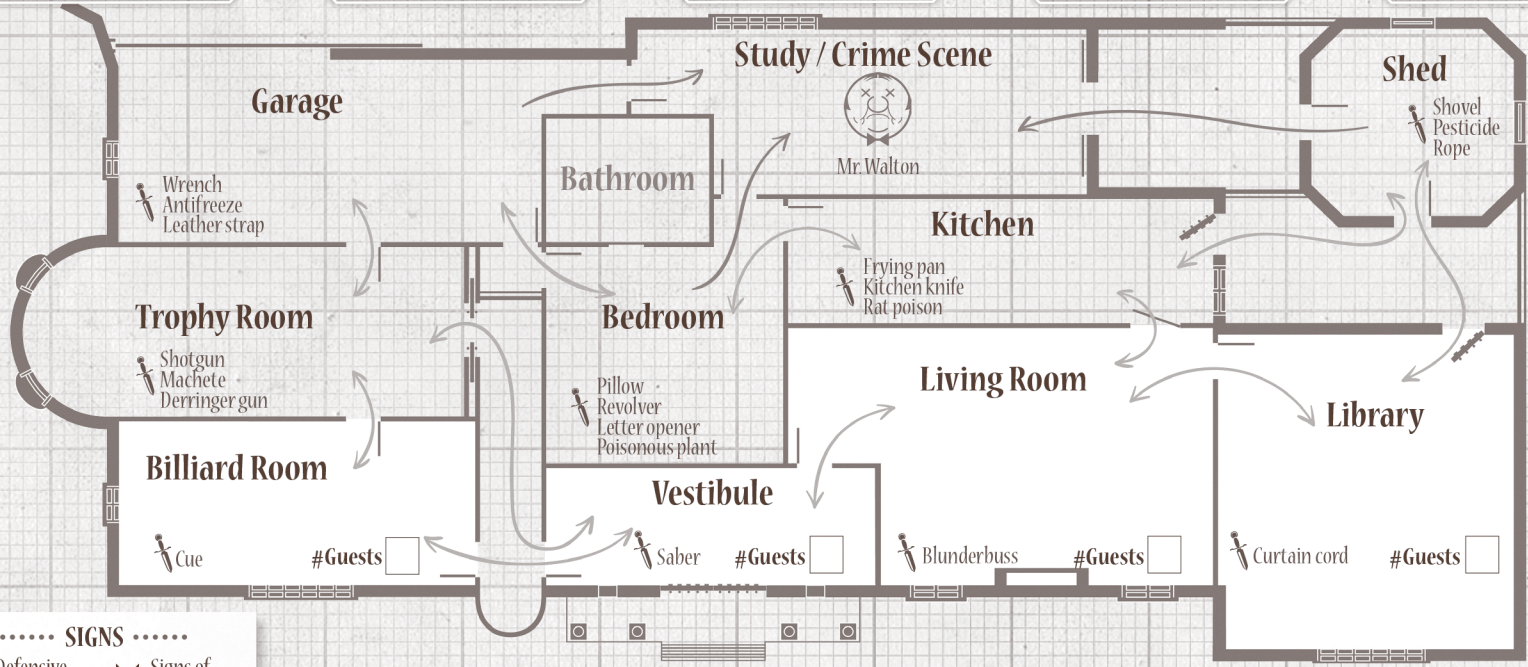

*Solution*

Who? .....

Why? .....

How? .....

Was there an accomplice?

No

Yes Who? .....

Why? .....

# The possible weapons

- ..... SIGNS .....
- Defensive wounds
  - Heavy bleeding
  - Attack from behind
  - Cyanosis or bruises
  - Traces of dirt
  - Signs of a fight
  - Oily substance
  - Traces of a dark powder
  - Burn marks
  - Strong odors

**Blunt weapons**

- Wrench Garage
- Shovel Shed
- Frying pan Kitchen
- Cue Billiard Room

**Firearms**

- Shotgun Trophy Room
- Revolver Bedroom
- Derringer gun Trophy Room
- Blunderbuss Living Room

**Bladed weapons**

- Kitchen knife Kitchen
- Machete Trophy Room
- Letter opener Bedroom
- Saber Vestibule

**Poisons**

- Antifreeze Garage
- Pesticide Shed
- Rat poison Kitchen
- Poisonous plant Bedroom

**Suffocating weapons**

- Leather strap Garage
- Rope Shed
- Pillow Bedroom
- Curtain cord Library